



STRADIVARI HORIZONTAL

SATIN STAINLESS STEEL

design **Luca Scacchetti**



10 YEARS WARRANTY

MATERIAL:

Vertical collectors in satin stainless steel.

Horizontal heating elements in satin stainless steel.

FIXING KIT:

Brackets, airvent, tappo, hexagonal tool, plugs and screws for mounting suitable for use on compact or hollow brick, installation notice.

PACKAGING:

The radiator is protected by a film in polyethylene and with a carton box. Use and maintenance notice included.

FEATURES:

It is totally made in stainless steel with an unalterable finishing.

Brightness guaranteed during the years.

Thermal outputs certified in accredited laboratories in compliance with European norm EN442.

PRODUCT CERTIFICATES



P. max: 8 bar

T. max: 110° C

Available for central heating systems

Connections: n° 4 x G 1/2"

AWARD

CASANOVA ROOM

NUMBER 3

ACCESSORIES



Elegant manual square satin valve

Copper connection Ø 12/14/15
Art. Nr. 5991990320209

Multilayer connection Ø 16 x2
Art. Nr. 5991990320208



Elegant square with thermostatic head satin valve

Copper connection Ø 12/14/15
Art. Nr. 5991990320197

Multilayer connection Ø 16 x2
Art. Nr. 5991990320196



Elegant corner dx with thermostatic head satin valve kit

Copper connection Ø 12/14/15
Art. Nr. 5991990320204

Multilayer connection Ø 16 x2
Art. Nr. 5991990320202



Straight hanger satin stainless steel (L= 420 mm)

Art. Nr. 5991990010159

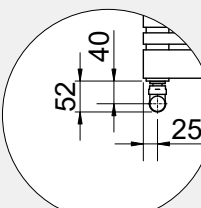

Measures for Elegant square manual valve



Pipe covering kit for satin valves

Art. Nr. 5103000000045



STAINLESS STEEL
MADE

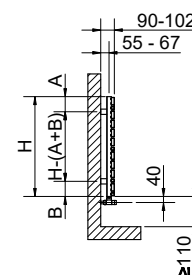
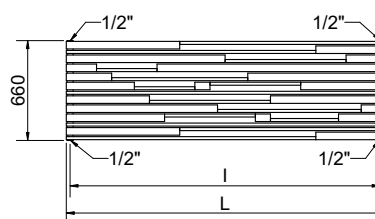
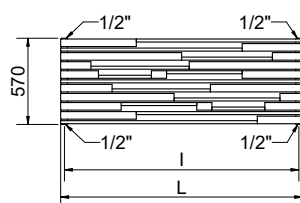
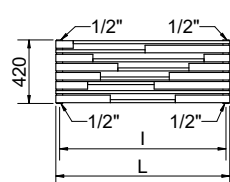
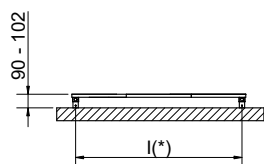
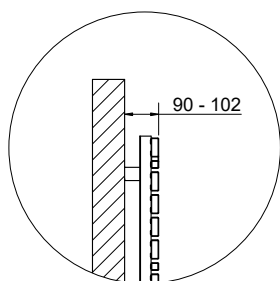

(*) The fixing kit has the same pipe centre (l) as the radiator

H [mm]	A [mm]	B [mm]
420	50	50
570	100	100
660	100	100

STRADIVARI HORIZONTAL - SATIN STAINLESS STEEL

Art. Nr.	Height	Width	Pipe Centres	Dry Weight	Surface	Water Content	Thermal output Watt		Exponent n
	H [mm]	L [mm]	l [mm]	[Kg]	[m ²]	[lt]	Δt = 50°C	Δt = 30°C	
3620760450006	420	1150	1100	14	1,80	6	347	187	1,2100
3620760450003	570	1600	1550	25	2,40	9,3	656	355	1,2000
3620760450004	660	2100	2050	37	3,14	15	997	540	1,2000

For output at different Δt than 50°C, please refer to the following formula = desired output = output at Δt 50°C x (desired Δt/50)ⁿ